

Hisense

10K
BTU

HiSmart™ PORTABLE
AIR CONDITIONER

up to 300 sq.ft.

Model AP10CW2G



Key Features

- Portable AC has wheels on it to make it easy to move from one room to another
- Smart functionality that enables you to control the portable AC from any location with your smart phone*
- Works with Amazon Alexa for voice control
- Programmable temperature feature for better efficiency
- Multi-directional automatic air flow for maximum comfort
- Multiple functions for personalized comfort (Cooling, Fan, and Dehumidifier)
- I-Feel™ Remote Control included so you can operate the AC from across the room



Quiet Operation

With an ultra-quiet compressor, and a new, cross-flow fan design, airflow is both strong and quiet, achieving just 47 dB(A) with the fan set on "Low".



Convenient Dual Display

A second, front-facing temperature display is easy to read, even from across the room.



I-Feel™ Remote Control

The I-Feel temperature sensor built into the remote control senses its surrounding temperature and transmits the signal back to the unit, providing maximum comfort.



Warranty

2 Years Parts & Labor

Cool Comfort. Smart Design.

Staying cool just became easier with the **Hisense HiSmart™ Portable Air Conditioner (Model AP10CW2G)**. The smart technology that it has enables you to control the AC with your smart phone from where ever you're located. With cloud-based connectivity via your iOS or Android™ smart phone and the free HiSmart Air App**, you'll always be in control. Featuring a built-in programmable thermostat —which can help you save money— changing your settings is just a click away. This AC comes with an easy-to-install window kit for windows 18" to 50" wide.

* Smart phone not included.

**App requires either iOS 8 or higher or Android 4.4 or higher. Home WiFi router required for pairing between product and smart phone.

All product, product specifications, and data are subject to change without notice to improve reliability, function, design or otherwise.

©2018 Hisense USA, All rights reserved

TECHNICAL SPECIFICATIONS

Performance	
Hisense Model	AP10CW G
Cooling Capacity (BTU)	10,000 BTU (ASHRAE-128-2001)
Heating Capacity	N/A
Maximum Cooling space	300 sq. ft.
Refrigerant	R-410A
Noise Level in dB(A)	47 - 49 dB(A)
Electrical	
Voltage / Freq / Amps	115V/60Hz / 10.4A
Control Features	
Unit Control Type	Hi-Smart Air App controllable
Fan Control	Button
Thermostat Control	61 - 86 °F
Display Type	Dual LED
Sleep Mode	Yes (on remote)
Dry Mode	Yes
Smart Mode	Yes (on remote)
Cooling Speeds	3 speeds
Temp Display Units	°C / °F
Clock	Yes (on remote)
Timer	24 Hr
Auto Restart	Yes
General Features	
Removable Filter	Yes
Washable PP Filter	Yes
Motorized Air Swing	Yes (on remote)
Vent System	Single Hose, 5.9"D x 59"L
Dehumidification	2.25 Pints / hr
Airflow (CFM)	185 - 230
Accessories	
Remote Control	Yes
AA Batteries	Yes - included
Air Hose	Yes
Window Kit	Yes
HiSmart Air App	Yes (iOS and Android™)
Approvals	
Safety	ETL
Energy	CEC
Parcel Shippable	No

Shipping	
Unit Dimension WxDxH (mm)	442x318x714
Carton Dimension WxDxH (mm)	498x386x885
Net Weight /Gross Weight (Kg)	29.2 / 31.9
Unit Dimension WxDxH (inch)	17.4x12.5x28.1
Carton Dimension WxDxH (inch)	19.6x15.3x34.9
Net Weight /Gross Weight (lbs)	64.4 / 70.9
Loading(40HQ)	425
Loading (53')	468 (floor loaded)
Warranty/UPC	
Parts & Labor	2 years
UPC	857603006201

How the HiSmart Air Home Appliance System Works



Window size requirements for the installation kit

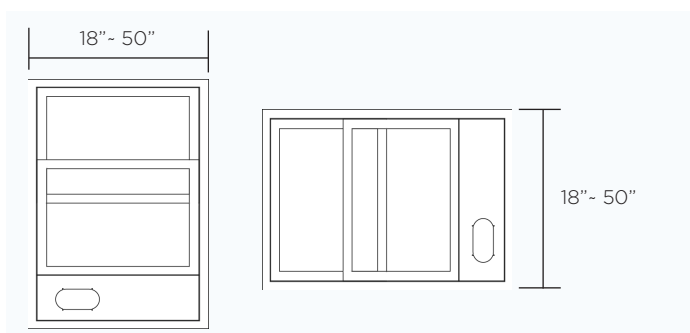

The window installation kit allows you to install the air conditioner in most vertical-sliding windows 18" to 50" wide, or horizontal-sliding windows from 18" to 50" high.

All product, product specifications, and data are subject to change without notice to improve reliability, function, design or otherwise. ©2018 Hisense USA, All rights reserved

Hisense USA Corporation
7310 McGinnis Ferry Road, Suwanee, GA, 30024
1-877-465-3566
www.hisense-usa.com

