

# Hisense

550  
SQ.FT

INVERTER  
DUAL-HOSE PORTABLE AIR CONDITIONER  
SACC 10,000BTU

Model AP1021TR1GD



- Dual-hose design operates as a true air conditioner
- Inverter technology provided quiet, efficient, and consistent cooling
- Program and manage temperature for better efficiency
- Cool, Dehumidify, and Fan Functions
- Remote Control is Included
- 2-year Warranty



**Dual-Hose Design Provides Faster Cooling** by eliminating the vacuum effect of standard portable air conditioners



**Inverter Technology**  
Energy efficient (up to 40% more efficiency)



**Quiet Operation**  
Achieve 42 dB(A) when the unit runs in "Quiet" mode



**Drain-free Operation (Cooling mode)**



**Easy Snap-Together Window Kit**

## Quiet, Efficient, Consistent, Cooling and Quick Installation

The Hisense AP1021TR1GD Portable Air Conditioner provides Fast Cooling with its Dual Hose design, by eliminating the vacuum effect of standard portable air conditioners. The Inverter technology delivers quiet, efficient, and consistent cooling. Airflow is strong and quiet because of the cross-flow fan design. The additional LED display on the front panel can be easily seen from across the room. The easy-to-install snap-together window kit fits windows 25" to 50" wide, helping preserve the external appearance of your home.

# Hisense

# 550 SQ.FT

## INVERTER DUAL HOSE PORTABLE AIR CONDITIONER SACC 10,000BTU

Model **AP1021TR1GD**

|   |                               |
|---|-------------------------------|
| <b>Model #</b>                                    | <b>AP1021TR1GD</b>            |
| <b>Performance</b>                                |                               |
| Maximum Cooling space                             | 550 sq.ft.                    |
| Cooling Capacity - SACC (BTU)                     | 10,000                        |
| CEER  | 7.8                           |
| Dehumidification Pint / 24 hr (at 26.7 / 19.4° C) | 79.2                          |
| Refrigerant                                       | R-32                          |
| Airflow (CFM)                                     | 165 – 224                     |
| Noise Level in dB(A)                              | 42 - 51                       |
| <b>Electrical</b>                                 |                               |
| Voltage / Freq / Amps                             | 115V / 60Hz, 12A* / 11.8A     |
| Plug Type / NEMA#                                 | A / 5-15P                     |
| Power Cord Length (feet)                          | 4.9                           |
| <b>Control Features</b>                           |                               |
| Unit Control Type                                 | Electronic                    |
| Fan Control                                       | Button                        |
| Thermostat Control                                | 61 - 86 °F                    |
| Display Type                                      | Dimmable LED                  |
| Sleep Mode  | Yes (on remote)               |
| Dehumidifier Mode                                 | Yes                           |
| Cooling Speeds                                    | 3 Speeds                      |
| Temp Display Units                                | °C / °F                       |
| Timer   | 1 Hr - 24Hr On/Off            |
| Auto Restart                                      | Yes (after power is restored) |
| <b>Inverter Technology</b>                        |                               |
| Quiet, Fast, Consistent Cooling                   | Yes                           |
| <b>General Features</b>                           |                               |
| Removable Filter                                  | Yes                           |
| Washable PP Filter                                | Yes                           |
| Oscillating Air Vent Louvers                      | Yes (on remote)               |
| Vent System                                       | Dual Hose, 5.9"0 x 59"L       |
| <b>Accessories</b>                                |                               |
| Remote Control                                    | Yes                           |
| AAA Batteries                                     | Yes                           |
| Air Hose  | Yes                           |
| Window Kit  | Yes                           |
| <b>Approvals</b>                                  |                               |
| Safety  | ETL                           |
| Energy Star                                       | No                            |

|                               |                    |
|-------------------------------|--------------------|
| <b>Product Dimensions</b>     |                    |
| Unit Dimension W x H x D (mm) | 442 x 738 x 365    |
| Net Weight (Kg)               | 31.7               |
| Unit Dimension WxHxD (inch)   | 17.4 x 29.1 x 14.4 |
| Net Weight (lbs)              | 69.9               |
| <b>Product</b>                |                    |
| Parts & Labor                 | 2 years            |
| UPC                           | 819130027418       |

Note:

\*: Rated Amps(A) / accorded UL 60335 Safety

### Benefit of Inverter Technology

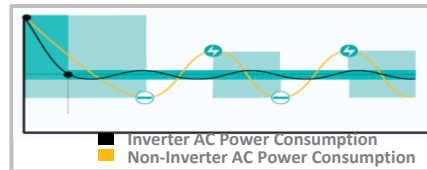

Up to 40% more Efficiency, compared to Inverter single hose Portable AC



Achieve 42 dB(A) when the unit runs in "Quiet" mode

### Control Panel



### Window Size

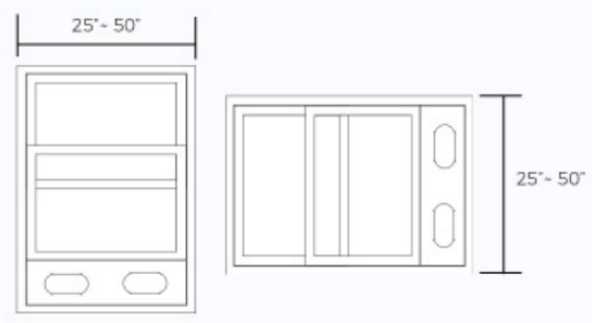

The window installation kit allows you to install the air conditioner in most vertical sliding windows 25" to 50" wide, or horizontal sliding windows from 18" to 50" high.

All product, product specifications, and data are subject to change without notice to improve reliability, function, design or otherwise.

©2021 HisenseUSA. All rights reserved

HisenseUSA Corporation  
7310 McGinnis Ferry Road, Suwanee, GA, 30024  
1-877-465-3566  
[www.hisense-usa.com](http://www.hisense-usa.com)